

# An Orienteering Map Of VISCHER FERRY NATURE AND HISTORIC PRESERVE

Clifton Park, New York

Scale 1:15,000  
Contours 3 m

The meridians are drawn to magnetic north; no adjustment is needed for declination.

LEGEND					
	lake, pond, water hole		contour, index contour		paved road, unpaved lot
	stream: wide, narrow		form line, rootstock, ditch		dirt road
	stream: intermittent, trickle		dot knoll, pit, depression		major trail
	uncrossable marsh		dike, large depression		foot path
	crossable marsh, wet ground				overgrown trail
	distinct vegetation boundary		open land		manmade object, hunters stand
	slow run, walk, fight		land: rough open, semi-open		power lines
	trees: coniferous, deciduous		felled area, sandy ground		
	undergrowth: slow, fight				

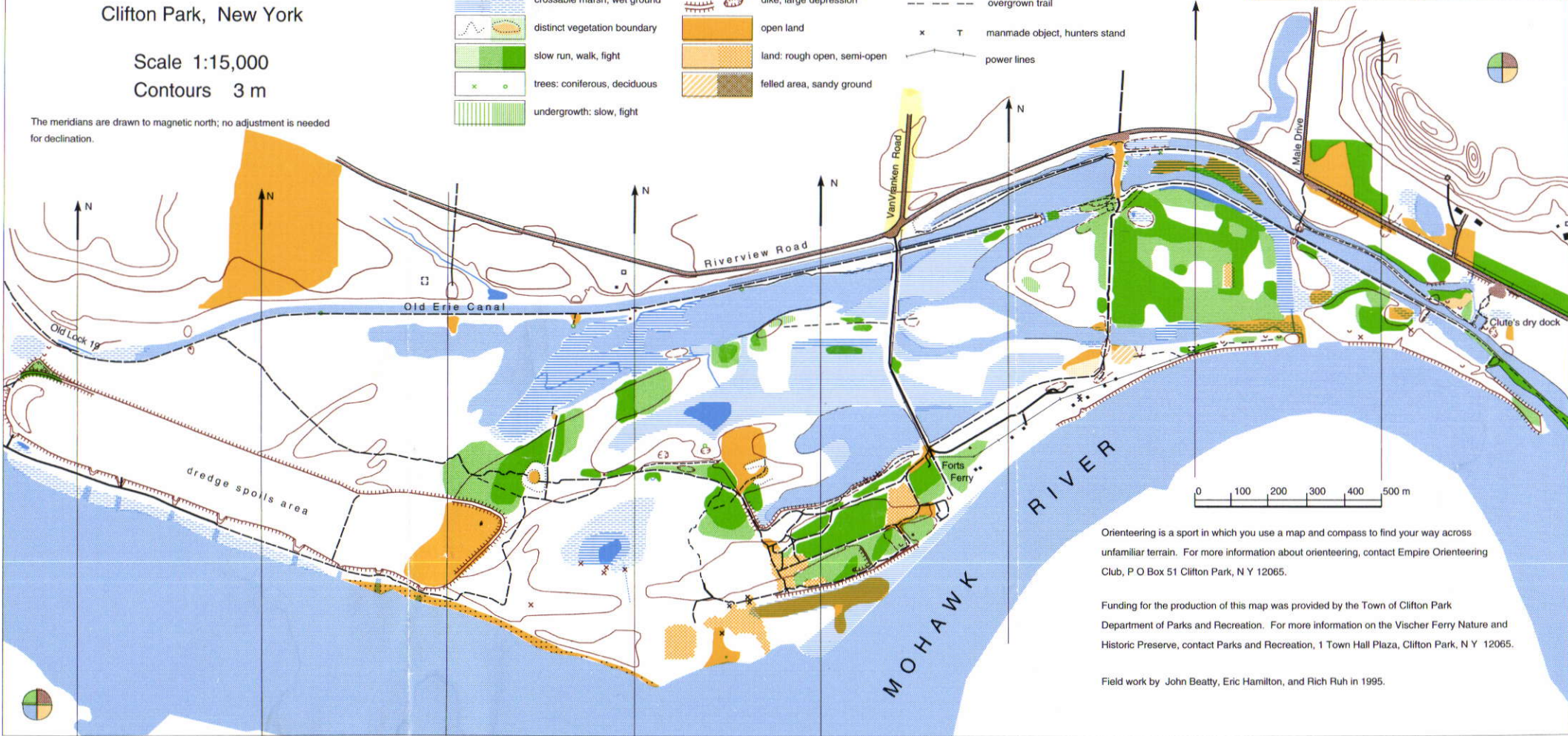
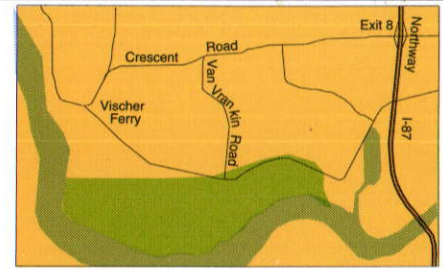

Orienteering is a sport in which you use a map and compass to find your way across unfamiliar terrain. For more information about orienteering, contact Empire Orienteering Club, P O Box 51 Clifton Park, N Y 12065.

Funding for the production of this map was provided by the Town of Clifton Park Department of Parks and Recreation. For more information on the Vischer Ferry Nature and Historic Preserve, contact Parks and Recreation, 1 Town Hall Plaza, Clifton Park, N Y 12065.

Field work by John Beatty, Eric Hamilton, and Rich Ruh in 1995.